

MLS #: L15666A List Price: \$99,500

0 off Hwy 231 GOSHEN, AL 36035



Property Features

COUNTY ROAD:	ROAD FRONTAGE: yes
AREA: Goshen	ACCESS ROADS:
SUBDIVISION:	ACCESSIBLE TRANSPORTATION: State Maintained Road
ELEMENTARY SCHOOL: Goshen	BEST USE: Residential, Investment
MIDDLE SCHOOL: Goshen	UTILITIES: Electricity, Cable TV, Utility Easements
HIGH SCHOOL: Goshen	WATER/SEWER: Public Water, Septic Tank
TYPE PROPERTY: Vacant Land, Undeveloped	BUILDINGS ON PROPERTY: None
TOPOGRAPHY: Level, Rolling, Wooded, Cleared	SALE OPTIONS: Will Sell
APX TTL ACREAGE +/-: 20	CONVEYANCES: Fee Simple
WOODED ACRES: 10	MISCELLANEOUS: Street Paved
CLEARED ACRES: 10	

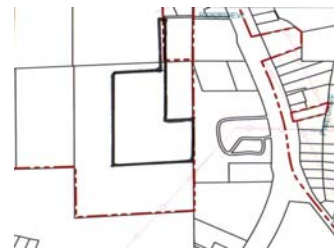

REMARKS: Property is 20 acres near Troy. Scattered timber. Great homesite.